

**DATE:** SEPTEMBER 5, 2002  
**MODEL YEAR:** 1999 AND AFTER  
**VEHICLE MODEL:** UD1200/1400/1800CS  
**BULLETIN #:** EF - 16  
 FILE IN THE ENGINE SECTION OF THE TECHNICAL BULLETIN BINDER

## AISIN THROTTLE POSITION SENSOR WITH MOUNTING BRACKET

### PURPOSE

To advise UD Truck Dealer Service personnel that the existing throttle position sensor, part number 19138-29000, is no longer available. However, it is recommended for dealers to use their existing stock of this part before ordering the new throttle position sensor kit.

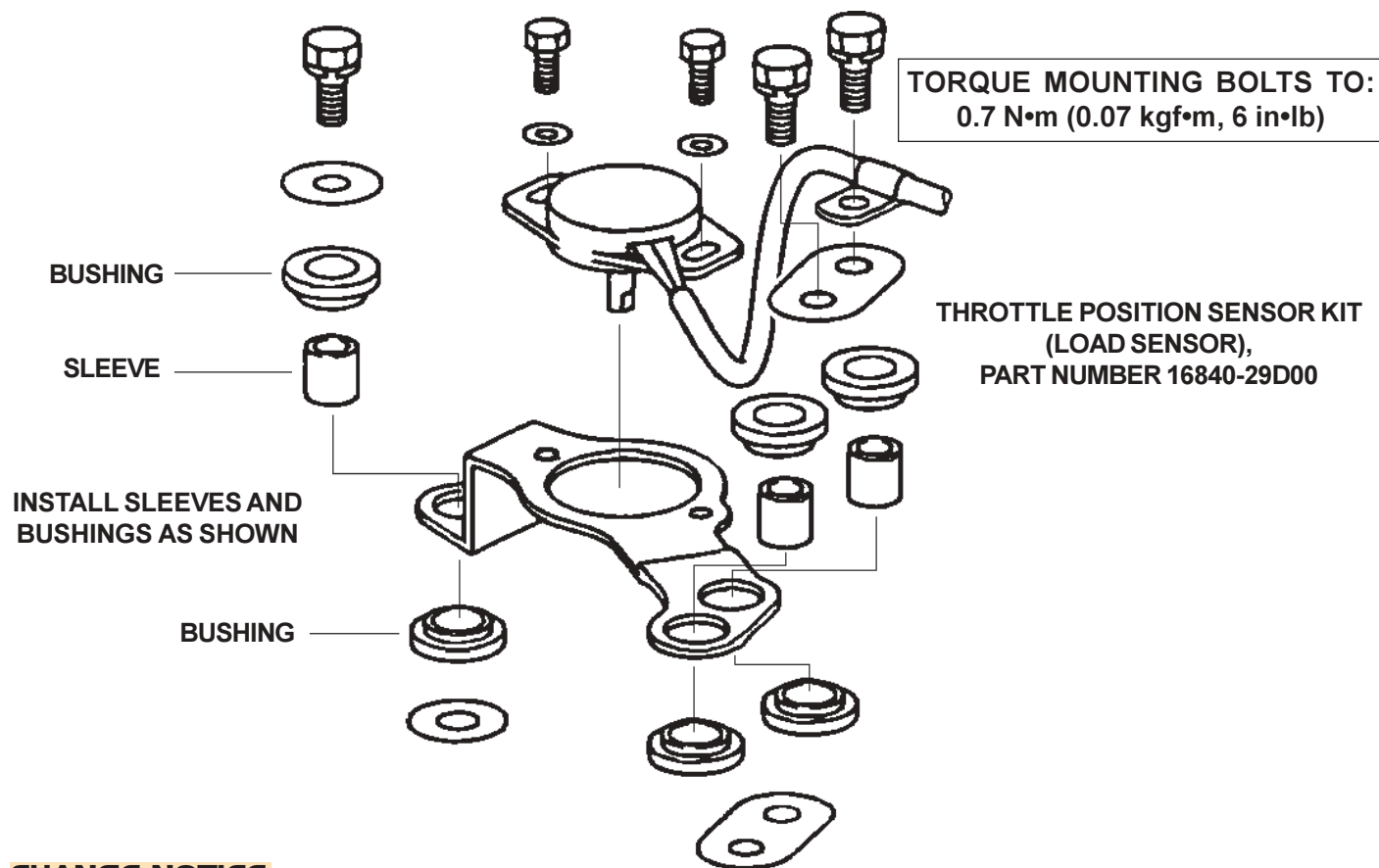

### CHANGE NOTICE

The revised throttle position sensor, kit part number 16840-29D00, includes a mounting bracket with bushings and sleeves as illustrated. Please refer to the recommended torque values for the attaching hardware.

<b>THE INFORMATION CONTAINED IN THIS BULLETIN SHOULD NOT BE CONSIDERED THE BASIS FOR WARRANTY CLAIMS</b>									
FOR THE INDICATED PERSONNEL BELOW, PLEASE READ, INITIAL, AND ROUTE TO THE FOLLOWING:									
X	SERVICE MANAGER	X	WARRANTY MANAGER	X	SERVICE TECHNICIANS INITIAL BELOW:				
X	PARTS MANAGER	X	SHOP FOREMAN						